

Product Documentation



Product Name: Grab Bar Set, Bend End CC
300mm

Article Number: 14.7510.02.302
Satin stainless steel
16.7510.01.302
Polished stainless steel

Picture:



Drawing:

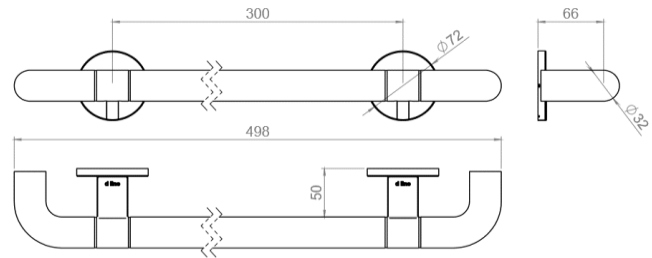

Product Information:

Material: AISI 316 stainless steel
Surface: Satin 320 grain or polished

Product Specification:

d line grab rail Ø32mm AISI 316 satin stainless steel.

Overall dimensions:

Height: 72mm
Width: 498mm
Depth: 82mm

d line products are always produced in the highest quality. d line is a simple and functional design, but the minimalistic exterior hides advanced technic that ensures the hardware's strength and durability for many years

Certificate: -

Warranty: 20 years

Spare Parts / Accessories:

Related Products:

Mounting:

Drill template enclosed product. Please use the correct screws and plugs for the type of wall.

Packing

1pcs per box

Maintenance:

Wash down with mild detergent, rinse off with clean water and dry off with soft dry cloth.

Environment:

No environmental risk and no risk of fire